

FOR SALE



4333 WILSHIRE BOULEVARD

Los Angeles, CA 90010

0.53 AC | 6,607 SF

PROPERTY HIGHLIGHTS

- 0.53 AC with freestanding 6,607 SF building
- 21 parking spaces
- CR (PKM-1) zoning
- 220' of frontage along Wilshire Boulevard
- Located in the highly affluent neighborhood of Hancock Park
- For Sale: \$5,250,000

FOR MORE INFORMATION, PLEASE CONTACT:

Steve Algermissen

Executive Director

+1 213 361 9546

steve.algermissen@cushwake.com

CA Lic 00816707

Robert Kuzman

Executive Director

+1 858 205 5439

robert.kuzman@cushwake.com

CA Lic 01312899

900 Wilshire Blvd,
Ste. 2400
Los Angeles, CA 90017
+1 213 955 5100
cushmanwakefield.com

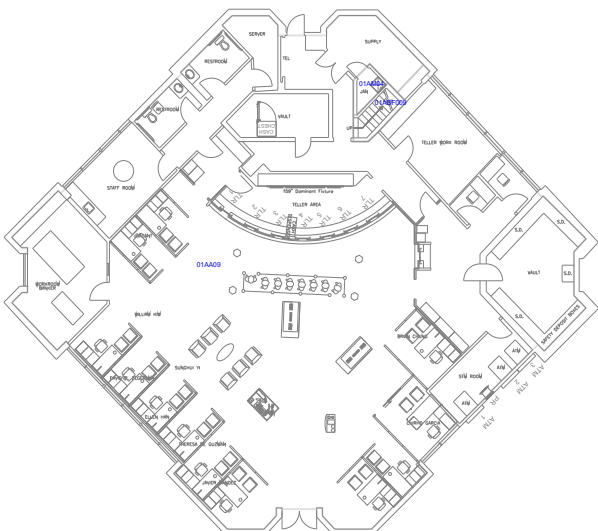

FOR SALE



4333 WILSHIRE BOULEVARD

Los Angeles, CA 90010

0.53 AC | 6,607 SF



	1 MILE	3 MILES	5 MILES	TRAFFIC COUNT:
Population	47,326	587,831	1,160,866	Wilshire Boulevard 46,548 VPD
Average HH Income	\$135,582	\$102,795	\$116,672	
Median Age	21,156	256,406	508,468	

©2026 Cushman & Wakefield. All rights reserved. The information contained in this communication is strictly confidential. This information has been obtained from sources believed to be reliable but has not been verified. NO WARRANTY OR REPRESENTATION, EXPRESS OR IMPLIED, IS MADE AS TO THE CONDITION OF THE PROPERTY (OR PROPERTIES) REFERENCED HEREIN OR AS TO THE ACCURACY OR COMPLETENESS OF THE INFORMATION CONTAINED HEREIN, AND SAME IS SUBMITTED SUBJECT TO ERRORS, OMISSIONS, CHANGE OF PRICE, RENTAL OR OTHER CONDITIONS, WITHDRAWAL WITHOUT NOTICE, AND TO ANY SPECIAL LISTING CONDITIONS IMPOSED BY THE PROPERTY OWNER(S). ANY PROJECTIONS, OPINIONS OR ESTIMATES ARE SUBJECT TO UNCERTAINTY AND DO NOT SIGNIFY CURRENT OR FUTURE PROPERTY PERFORMANCE. PD-209080-V1