

FOR LEASE



PRIME WESTSIDE LOCATION



WESTGATE DISTRIBUTION CENTER

5535 COMMONWEALTH AVE
JACKSONVILLE, FL 32254

PROPERTY HIGHLIGHTS

Westgate Distribution Center is located at one of the major intersections in the heart of the Westside Industrial Market (Commonwealth & Ellis). Ideal for warehousing and distribution.

- 23' Clear Height
- 33'-4" x 30' Column Spacing
- Signage Available
- Dock High and Drive-In Loading
- End-Cap Unit

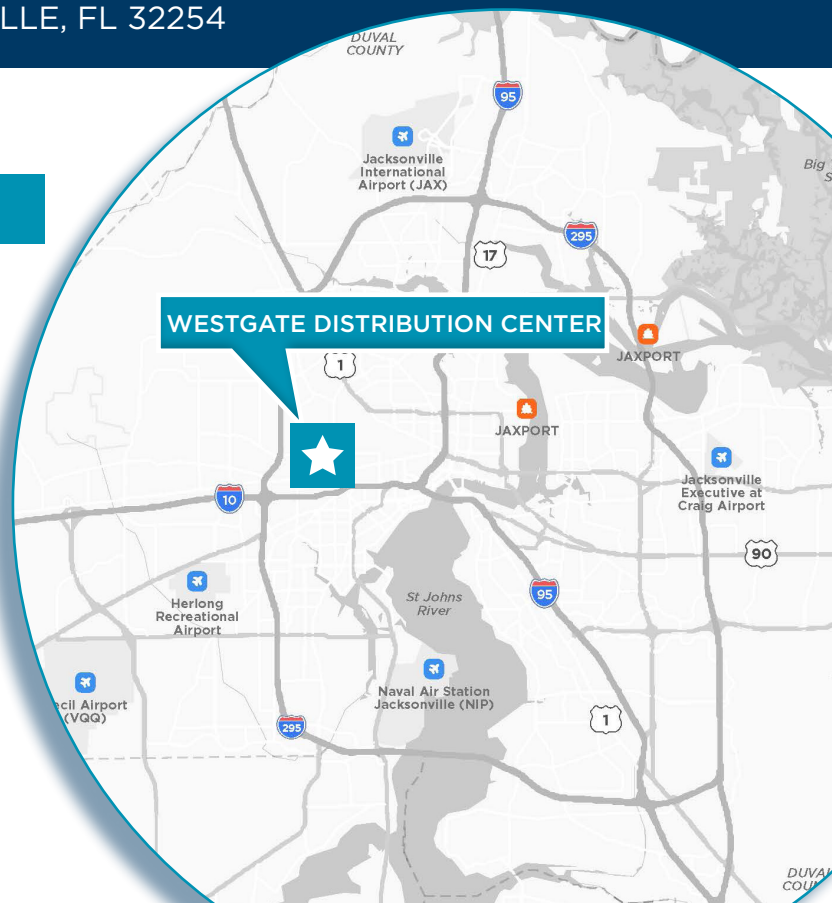

FLOORPLANS

SUITE 5535

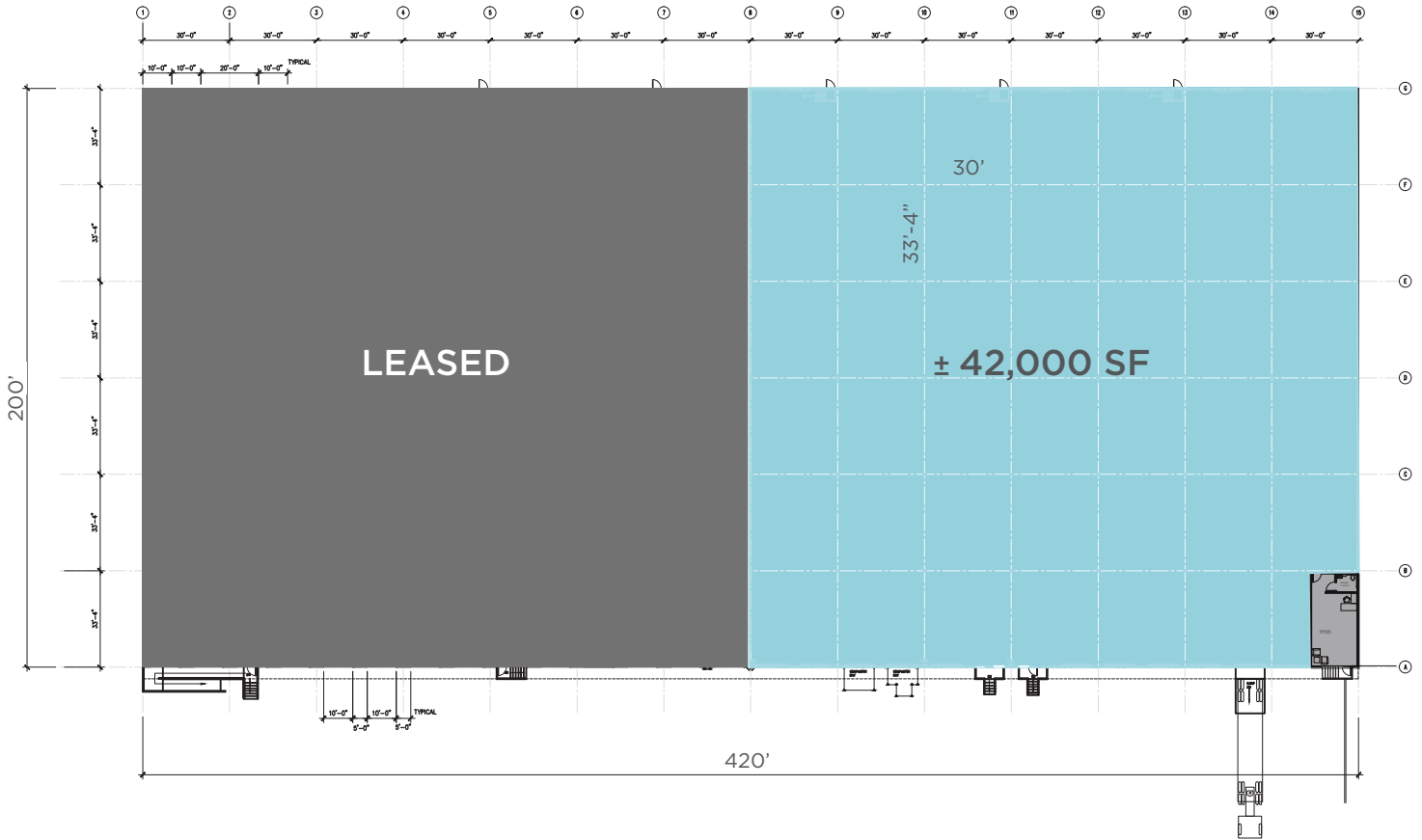

Office - ±526 SF

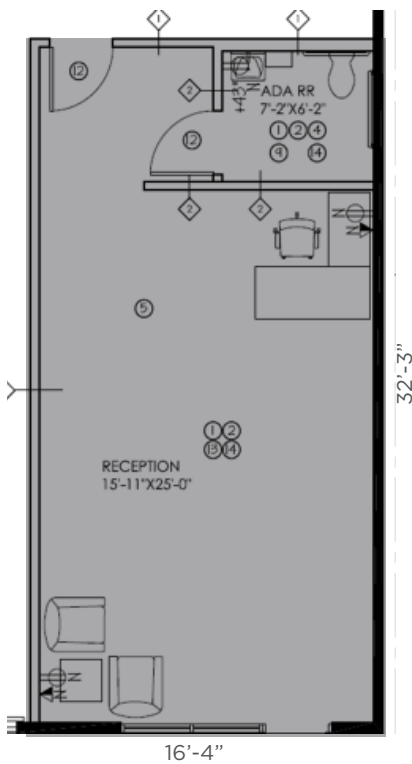

Property Highlights

AVAILABLE SPACE:	± 42,000 SF
OFFICE:	± 526 SF
CLEAR HEIGHT:	23'
DOCKS:	10
RAMP:	1
LIGHTING:	LED
COLUMNS:	33'-4" x 30'
BUILDING DEPTH:	200'
FIRE SUPPRESSION:	Wet
POWER:	3 Phase, 120/208 Volt Service

PROPERTY AERIAL



FOR LEASE
± 42,000 SF
Available

WESTGATE DISTRIBUTION CENTER

5535 COMMONWEALTH AVE
JACKSONVILLE, FL 32254

SITE PLAN

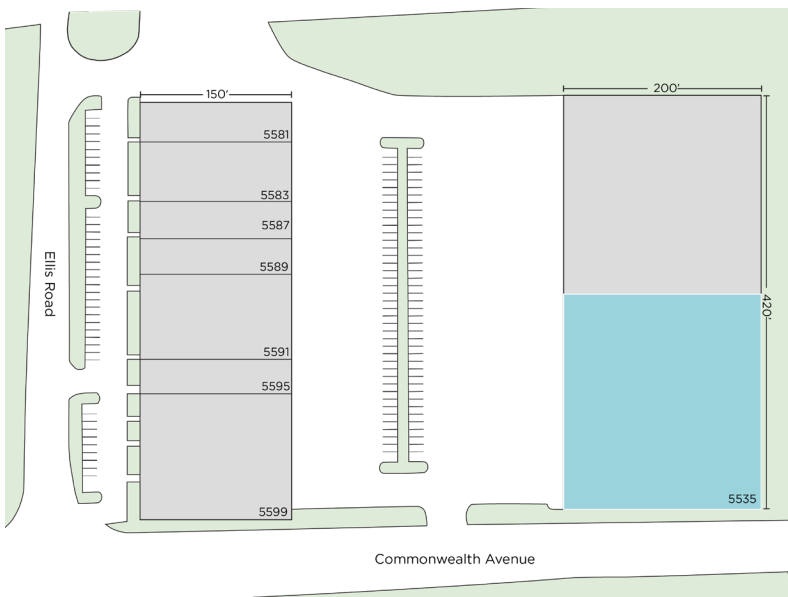

CONTACT INFORMATION

TYLER NEWMAN
Executive Managing Director
tyler.newman@cushwake.com
904-710-9927

KENDALL WILSON
Industrial Real Estate Specialist
kendall.wilson@cushwake.com
904-525 7671

PHOTO



©2026 Cushman & Wakefield. All rights reserved. The information contained in this communication is strictly confidential. This information has been obtained from sources believed to be reliable but has not been verified. NO WARRANTY OR REPRESENTATION, EXPRESS OR IMPLIED, IS MADE AS TO THE CONDITION OF THE PROPERTY (OR PROPERTIES) REFERENCED HEREIN OR AS TO THE ACCURACY OR COMPLETENESS OF THE INFORMATION CONTAINED HEREIN, AND SAME IS SUBMITTED SUBJECT TO ERRORS, OMISSIONS, CHANGE OF PRICE, RENTAL OR OTHER CONDITIONS, WITHDRAWAL WITHOUT NOTICE, AND TO ANY SPECIAL LISTING CONDITIONS IMPOSED BY THE PROPERTY OWNER(S). ANY PROJECTIONS, OPINIONS OR ESTIMATES ARE SUBJECT TO UNCERTAINTY AND DO NOT SIGNIFY CURRENT OR FUTURE PROPERTY PERFORMANCE.