

1775

WOODSIDE

WWW.1775WOODSIDE.COM

Ben Paul

Vice Chairman

+1 650 401 2123

ben.paul@cushwake.com

LIC #01210872

Chris Blom

Director

+1 650 931 2210

chris.blom@cushwake.com

LIC #02031205

Jed Springer

Director

+1 650 320 0210

jed.springer@cushwake.com

LIC #02012629

©2024 Cushman & Wakefield. All rights reserved. The information contained in this communication is strictly confidential. This information has been obtained from sources believed to be reliable but has not been verified. NO WARRANTY OR REPRESENTATION, EXPRESS OR IMPLIED, IS MADE AS TO THE CONDITION OF THE PROPERTY (OR PROPERTIES) REFERENCED HEREIN OR AS TO THE ACCURACY OR COMPLETENESS OF THE INFORMATION CONTAINED HEREIN, AND SAME IS SUBMITTED SUBJECT TO ERRORS, OMISSIONS, CHANGE OF PRICE, RENTAL, OR OTHER CONDITIONS, WITHDRAWAL WITHOUT NOTICE, AND TO ANY SPECIAL LISTING CONDITIONS IMPOSED BY THE PROPERTY OWNER(S). ANY PROJECTIONS, OPINIONS OR ESTIMATES ARE SUBJECT TO UNCERTAINTY AND DO NOT SIGNIFY CURRENT OR FUTURE PROPERTY PERFORMANCE. COE-PM-West-10.1.2024



**2,500 RSF -
5,520 RSF
AVAILABLE**

PROPERTY HIGHLIGHTS

Full interior, exterior & lobby renovations.
2 brand new spec suites with all glass
office/conference rooms and kitchens
in every suite.

- Covered parking available onsite with EV charging
- Monument signage with nighttime lighting available – High traffic count + visibility

AVAILABILITIES:

Suite 301* 5,520 RSF

*divisible to ±2,500 RSF

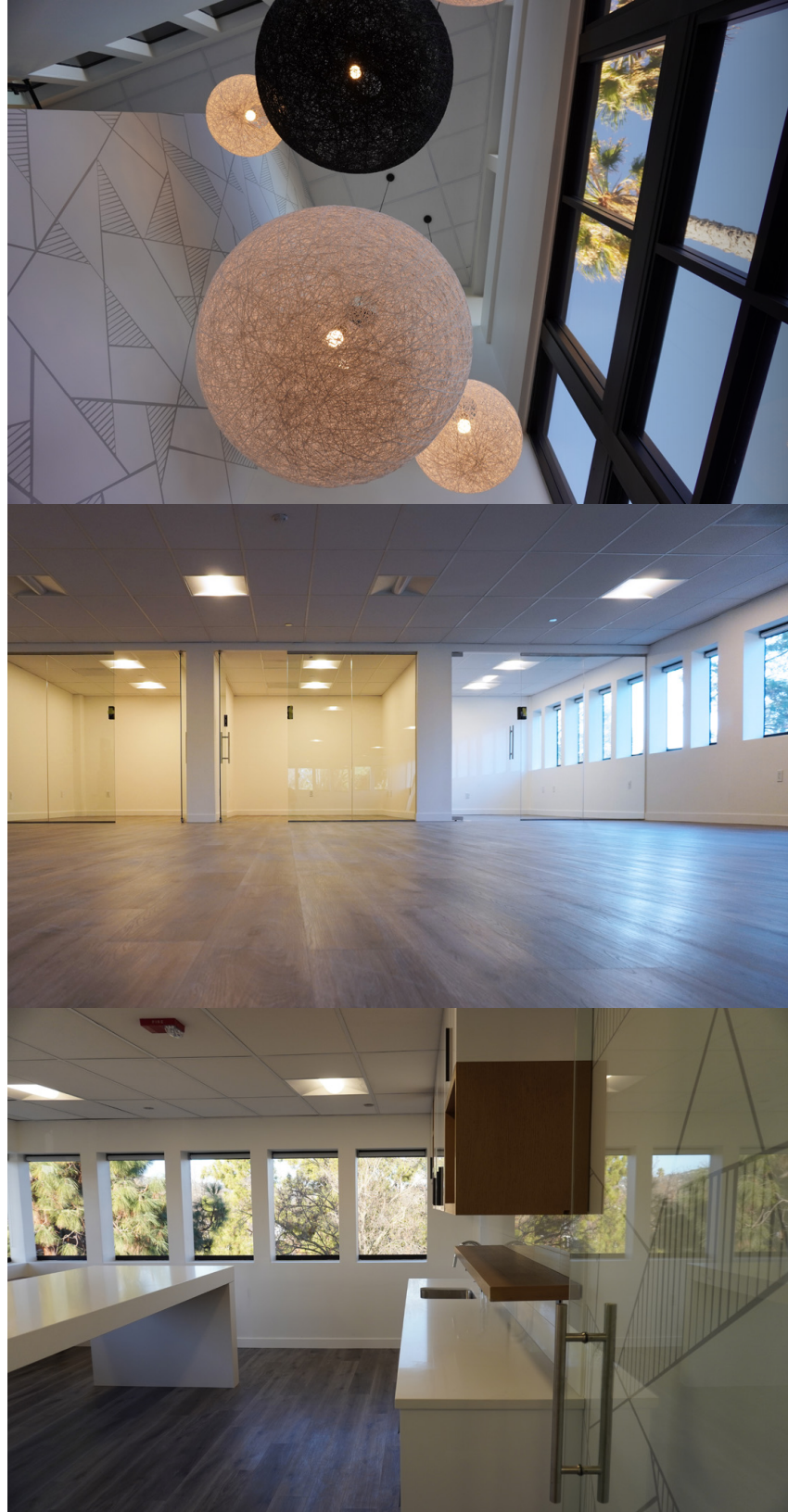

5775

WOODSIDE

WWW.1775WOODSIDE.COM

Ben Paul
Vice Chairman
+1 650 401 2123
ben.paul@cushwake.com
LIC #01210872

Chris Blom
Director
+1 650 931 2210
chris.blom@cushwake.com
LIC #02031205

Jed Springer
Director
+1 650 320 0210
jed.springer@cushwake.com
LIC #02012629

©2024 Cushman & Wakefield. All rights reserved. The information contained in this communication is strictly confidential. This information has been obtained from sources believed to be reliable but has not been verified. NO WARRANTY OR REPRESENTATION, EXPRESS OR IMPLIED, IS MADE AS TO THE CONDITION OF THE PROPERTY (OR PROPERTIES) REFERENCED HEREIN OR AS TO THE ACCURACY OR COMPLETENESS OF THE INFORMATION CONTAINED HEREIN, AND SAME IS SUBMITTED SUBJECT TO ERRORS, OMISSIONS, CHANGE OF PRICE, RENTAL OR OTHER CONDITIONS, WITHDRAWAL WITHOUT NOTICE, AND TO ANY SPECIAL LISTING CONDITIONS IMPOSED BY THE PROPERTY OWNER(S). ANY PROJECTIONS, OPINIONS OR ESTIMATES ARE SUBJECT TO UNCERTAINTY AND DO NOT SIGNIFY CURRENT OR FUTURE PROPERTY PERFORMANCE. COE:PM-West-10.1.2024

**2,500 RSF -
5,520 RSF
AVAILABLE**

FLOORPLANS 3RD FLOOR

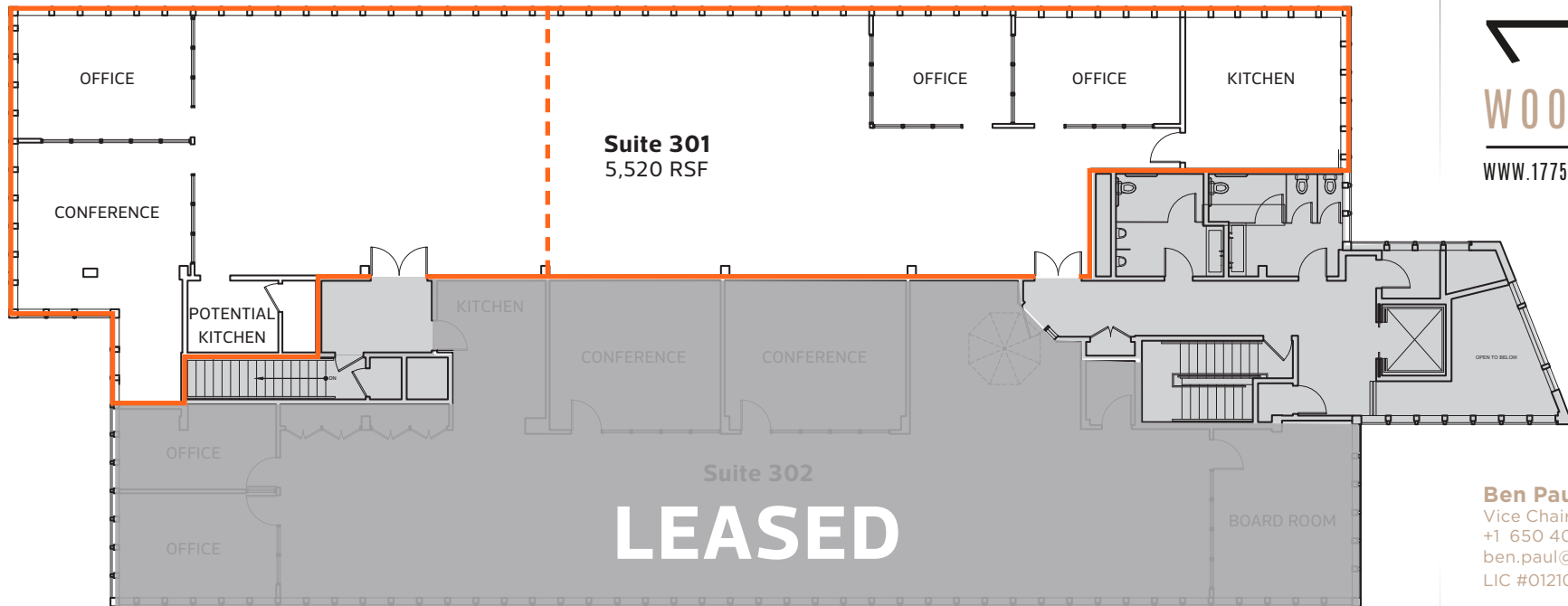

- COMMON AREA
- HYPOTHETICAL DIVISION

1775

WOODSIDE

WWW.1775WOODSIDE.COM

Ben Paul
Vice Chairman
+1 650 401 2123
ben.paul@cushwake.com
LIC #01210872

Chris Blom
Director
+1 650 931 2210
chris.blom@cushwake.com
LIC #02031205

Jed Springer
Director
+1 650 320 0210
jed.springer@cushwake.com
LIC #02012629



Cushman & Wakefield Copyright 2021.
No warranty or representation, express or implied, is made to the accuracy or completeness of the information contained herein, and same is submitted subject to errors, omissions, change of price, rental or other conditions, withdrawal without notice, and to any special listing conditions imposed by the property owner(s). As applicable, we make no representation as to the condition of the property (or properties) in question.

1775

WOODSIDE

WWW.1775WOODSIDE.COM

Ben Paul
Vice Chairman
+1 650 401 2123
ben.paul@cushwake.com
LIC #0210872

Chris Blom
Director
+1 650 931 2210
chris.blom@cushwake.com
LIC #02031205

Jed Springer
Director
+1 650 320 0210
jed.springer@cushwake.com
LIC #02012629

©2024 Cushman & Wakefield. All rights reserved. The information contained in this communication is strictly confidential. This information has been obtained from sources believed to be reliable but has not been verified. NO WARRANTY OR REPRESENTATION, EXPRESS OR IMPLIED, IS MADE AS TO THE CONDITION OF THE PROPERTY (OR PROPERTIES) REFERENCED HEREIN OR AS TO THE ACCURACY OR COMPLETENESS OF THE INFORMATION CONTAINED HEREIN, AND SAME IS SUBMITTED SUBJECT TO ERRORS, OMISSIONS, CHANGE OF PRICE, RENTAL, OR OTHER CONDITIONS, WITHDRAWAL WITHOUT NOTICE, AND TO ANY SPECIAL LISTING CONDITIONS IMPOSED BY THE PROPERTY OWNER(S). ANY PROJECTIONS, OPINIONS OR ESTIMATES ARE SUBJECT TO UNCERTAINTY AND DO NOT SIGNIFY CURRENT OR FUTURE PROPERTY PERFORMANCE. COE:PM-West-10.1.2024

**2,500 RSF -
5,520 RSF
AVAILABLE**



4 MINUTES TO HIGHWAY 280
7 MINUTES TO HIGHWAY 101
10 MINUTES TO DOWNTOWN
REDWOOD CITY AND ACCESS TO
100's OF AMENITIES

1775

WOODSIDE

WWW.1775WOODSIDE.COM



★ - 1775 Woodside Road
Redwood City, CA

RESTAURANTS/CAFES

- 1 - S'Bastians Coffee
Villa Lucias
- 2 - Redwood Grill
Breaker's Cafe
Lucky
- 3 - Round Table Pizza
Sushi Plus Sushi Restaurant
Old Port Lobster Shack
Yat Sing Restaurant
- 4 - Espresso Lane-An Express Cafe
- 5 - Starbucks
VIVI's Cafe

FINANCIAL/BANKS

- 1 - U.S. Bank
- 2 - Citi Bank

FITNESS/HEALTH

- 1 - Mobius Fit

Ben Paul
Vice Chairman
+1 650 401 2123
ben.paul@cushwake.com
LIC #01210872

Chris Blom
Director
+1 650 931 2210
chris.blom@cushwake.com
LIC #02031205

Jed Springer
Director
+1 650 320 0210
jed.springer@cushwake.com
LIC #02012629

©2024 Cushman & Wakefield. All rights reserved. The information contained in this communication is strictly confidential. This information has been obtained from sources believed to be reliable but has not been verified. NO WARRANTY OR REPRESENTATION, EXPRESS OR IMPLIED, IS MADE AS TO THE CONDITION OF THE PROPERTY (OR PROPERTIES) REFERENCED HEREIN OR AS TO THE ACCURACY OR COMPLETENESS OF THE INFORMATION CONTAINED HEREIN, AND SAME IS SUBMITTED SUBJECT TO ERRORS, OMISSIONS, CHANGE OF PRICE, RENTAL OR OTHER CONDITIONS, WITHDRAWAL WITHOUT NOTICE, AND TO ANY SPECIAL LISTING CONDITIONS IMPOSED BY THE PROPERTY OWNER(S). ANY PROJECTIONS, OPINIONS OR ESTIMATES ARE SUBJECT TO UNCERTAINTY AND DO NOT SIGNIFY CURRENT OR FUTURE PROPERTY PERFORMANCE. COE-PM-West-101.2024

